

⚠ Important Notes

- Turn off the device after use. It will NOT turn off automatically.
- Do NOT open the device. Opening causes permanent damage and voids the warranty.

Description

- ① **Sensor Connector** – Connect to analog sensor
- ② **Tri Color LED**
 - – Device is on
 - – Device is in charge
 - – Device is fully charged
- ③ **Charging Port** – Connect to cable to charge WiMER10
- ④ **On/Off Button** – Press to turn WiMER10 On/Off
- ⑤ **External Antenna**

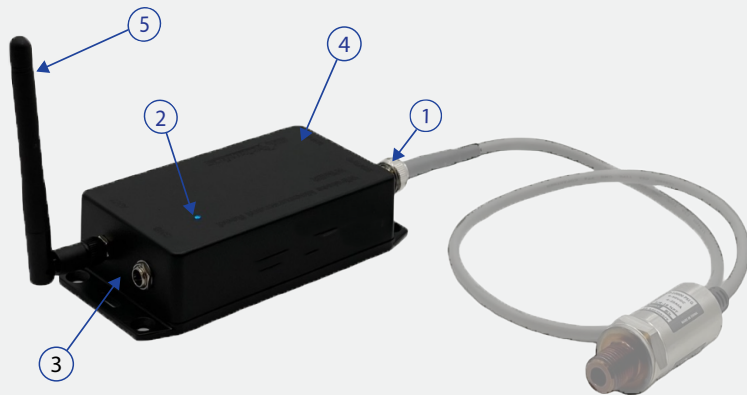

Included in the Package

- WiMER10 Base
- USB Charging Cable
- USB Power Adapter
- User Guide

Compatible Software

- iOS: MultiGage Reader
- Android: MultiGage Reader
- Windows: MultiGage Reader (BLE Dongle Required)
- iOS app can be directly downloaded from the app store for FREE
- Android app can be directly downloaded from the Google Play Store for FREE
- Windows software is available on Motionics website

Quick Start

- Connect analog sensor to WiMER10.
- Turn on your WiMER10.
- Plug in USB Bluetooth dongle, If you are using windows PC.
- Run the software, tap Scan/+button to enter pairing page.
- Wait for the software to finish scanning nearby devices, select WiMERXXXX to connect.
- Connection may take a few seconds, once paired, pressure readings appears in the software.